

Alco

Bi-Metal Lugs

FEATURES:

- Termination of aluminium and aluminium alloy conductors to copper busbars and terminals
- Friction welded aluminium/copper crimp lugs
- Suitable for use with standard 6 ton and 12 ton Australian hex crimp dies
- Printed with crimp indicator marks
- Pre-drilled copper palms
- Pre-greased aluminium barrels to reduce corrosion
- Hi purity aluminium 99.6%
- ETP Copper 99.9%
- All sizes can be sold individually

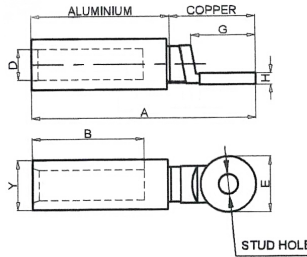

STANDARDS: AS4325.1

PART NUMBER	CONDUCTOR SIZE (mm²)	STUD HOLE SIZE (mm)	DIMENSIONS (mm)							PACK QTY	RECOMMENDED HEAT SHRINK		
			TOTAL LENGTH	INSIDE BARREL LENGTH	BARREL ID	BARREL OD	PALM WIDTH	TONGUE LENGTH	PALM THICKNESS		THIN WALL	MED WALL	THICK WALL
			A	B	D	Y	E	G	H				
ALCLCA16M10	16mm²	10.5	75	32	5.5	12	20	24	4.5	25	HSTNW13/6.5	HSMWGL16/5L	HSTKWGL13/4
ALCLCA25M10	25mm²	10.5	75	32	7.5	12	20	24	4.5	25	HSTNW13/6.5	HSMWGL16/5L	HSTKWGL19/6
ALCLCA35M10	35mm²	10.5	75	32	8.5	12	20	24	4.5	25	HSTNW18/9	HSMWGL25/8L	HSTKWGL19/6
ALCLCA35M12	35mm²	12.5	75	32	8.5	12	20	24	4.5	25	HSTNW18/9	HSMWGL25/8L	HSTKWGL19/6
ALCLCA50M10	50mm²	10.5	75	32	9.5	16	24	26	4.5	10	HSTNW18/9	HSMWGL25/8L	HSTKWGL19/6
ALCLCA50M12	50mm²	12.5	75	32	9.5	16	24	26	4.5	10	HSTNW18/9	HSMWGL25/8L	HSTKWGL19/6
ALCLCA70M10	70mm²	10.5	75	32	11.5	16	24	26	4.5	10	HSTNW22/11	HSMWGL25/8L	HSTKWGL19/6
ALCLCA70M12	70mm²	12.5	75	32	11.5	16	24	26	4.5	10	HSTNW22/11	HSMWGL25/8L	HSTKWGL19/6
ALCLCA95M10	95mm²	10.5	115	60	13.5	21.5	24	26	6	10	HSTNW22/11	HSMWGL25/8L	HSTKWGL28/9
ALCLCA95M12	95mm²	12.5	115	60	13.5	21.5	24	26	6	10	HSTNW22/11	HSMWGL25/8L	HSTKWGL28/9
ALCLCA120M10	120mm²	10.5	115	60	15.5	21.5	30	33	6	10	HSTNW40/20	HSMWGL35/12L	HSTKWGL28/9
ALCLCA120M12	120mm²	12.5	115	60	15.5	21.5	30	33	6	10	HSTNW40/20	HSMWGL35/12L	HSTKWGL28/9
ALCLCA150M10	150mm²	10.5	120	60	16.5	27	30	33	7	10	HSTNW40/20	HSMWGL35/12L	HSTKWGL38/12
ALCLCA150M12	150mm²	12.5	120	60	16.5	27	30	33	7	10	HSTNW40/20	HSMWGL35/12L	HSTKWGL38/12
ALCLCA185M10	180mm²	10.5	120	60	18.5	27	35	38	7	6	HSTNW40/20	HSMWGL35/12L	HSTKWGL38/12
ALCLCA185M12	180mm²	12.5	120	60	18.5	27	35	38	7	6	HSTNW40/20	HSMWGL35/12L	HSTKWGL38/12
ALCLCA240M10	240mm²	10.5	135	60	22	35	35	38	7	6	HSTNW40/20	HSMWGL50/16L	HSTKWGL38/12
ALCLCA240M12	240mm²	12.5	135	60	22	35	35	38	7	6	HSTNW40/20	HSMWGL50/16L	HSTKWGL38/12
ALCLCA300M10	300mm²	10.5	135	60	23.5	35	36	38	7	6	HSTNW40/20	HSMWGL50/16L	HSTKWGL51/16
ALCLCA300M12	300mm²	12.5	135	60	23.5	35	36	38	7	6	HSTNW40/20	HSMWGL50/16L	HSTKWGL51/16
ALCLCA400M10	400mm²	10.5	160	70	26.5	47	50	58	10	3	HSTNW50/25	HSMWGL50/16L	HSTKWGL51/16
ALCLCA400M12	400mm²	12.5	160	70	26.5	47	50	58	10	3	HSTNW50/25	HSMWGL50/16L	HSTKWGL51/16
ALCLCA500M10	500mm²	10.5	160	70	30	47	50	58	10	3	HSTNW50/25	HSMWGL50/16L	HSTKWGL51/16
ALCLCA500M12	500mm²	12.5	160	70	30	47	50	58	10	3	HSTNW50/25	HSMWGL50/16L	HSTKWGL51/16



Like us on Facebook
@Alco.cableglands



Follow us on Instagram
@alco_cableglands



P: 1 300 300 747
www.wattmaster.com.au