

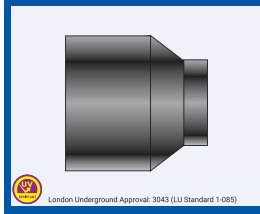

ACCESSORIES

Neoprene Short Shroud



Product Code	Size Reference	Metric Size
1521-0	0	M20
152101	1	M20
152102	2	M25
152103	3	M32
152104	4	M40
152105	5	M50
152106	6	M63
152107	7	M75

All dimensions are in mm.

Long Shroud

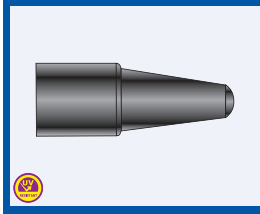

Product Code	Size Reference	Metric Size
1523-0	0	M20
152301	1	M20
152302	2	M25
152303	3	M32
152304	4	M40
152305	5	M50
152306	6	M63
152307	7	M75

All dimensions are in mm.

LSOH Long Shroud Grey

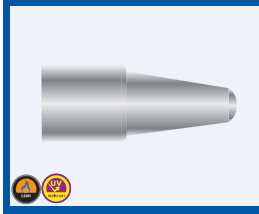

Product Code	Size Reference	Metric Size
1524-0	0	M20
152401	1	M20
152402	2	M25
152403	3	M32
152404	4	M40
152405	5	M50
152406	6	M63
152407	7	M75

All dimensions are in mm.

LSOH Shroud



Product Code	Size Reference	Metric Size
1526-0	0	M20
152601	1	M20
152602	2	M25
152603	3	M32
152604	4	M40
152605	5	M50
152606	6	M63
152607	7	M75
152608	8	M80
152609	9	M90
152610	10	M100
152611	11	M110

All dimensions are in mm.

LSOH-U Shroud Grey Long



Product Code	Size Reference	Metric Size
1528-0	0	M20
152801	1	M20
152802	2	M25
152803	3	M32
152804	4	M40

All dimensions are in mm.
For sizes larger than 4 use LSOH Shroud Grey Long.

PVC-U Shroud Orange Long

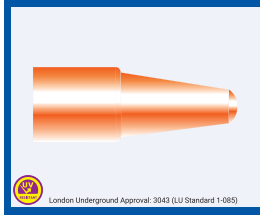

Product Code	Size Reference	Metric Size
1527-0-OR	0	M20
152701-OR	1	M20
152702-OR	2	M25
152703-OR	3	M32
152704-OR	4	M40
152705-OR	5	M50
152706-OR	6	M63
152707-OR	7	M75
152708-OR	8	M80
152709-OR	9	M90
152710-OR	10	M100

All dimensions are in mm.

PVC-U Shroud Black Long

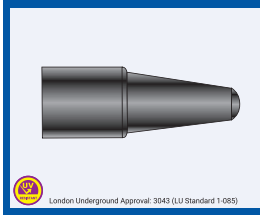

Product Code	Size Reference	Metric Size
1527-0	0	M20
152701	1	M20
152702	2	M25
152703	3	M32
152704	4	M40

All dimensions are in mm.
For sizes larger than 4 use PVC Shroud Black Long.

PVC Shroud Short

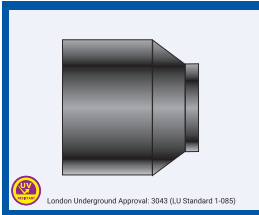

Product Code	Size Reference	Metric Size
1522-0	0	M20
152201	1	M20
152202	2	M25
152203	3	M32
152204	4	M40
152205	5	M50
152206	6	M63
152207	7	M75
152208	8	M80
152209	9	M90
152210	10	M100

All dimensions are in mm.

PVC Long Shroud

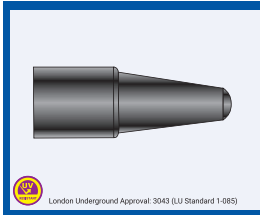

Product Code	Size Reference	Metric Size
1525-0	0	M20
152501	1	M20
152502	2	M25
152503	3	M32
152504	4	M40
152505	5	M50
152506	6	M63
152507	7	M75
152508	8	M80
152509	9	M90
152510	10	M100
152511	11	M110/115
152512	12	M120
152513	13	M130

All dimensions are in mm.

Brass Locknut (Nickel Plated)

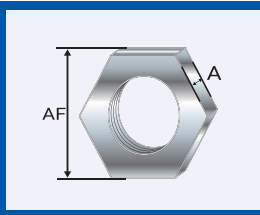

Product Code	Size Ref	Metric Size	Across Flats	THKNS (A)
300901-M16	0	M16x1.5	22	4
300901	1	M20x1.5	25	5
300902	2	M25x1.5	32	5
300903	3	M32x1.5	42	5
300904	4	M40x1.5	52	5
300905	5	M50x1.5	65	6
300906	6	M63x1.5	80	6
300907	7	M75x1.5	90	7
300908	8	M80x2.0	96	8
300909	9	M90x2.0	110	8

All dimensions are in mm.

ACCESSORIES

Slip-On Earth Tag

NICKEL PLATED BRASS OR STAINLESS STEEL 316/316L

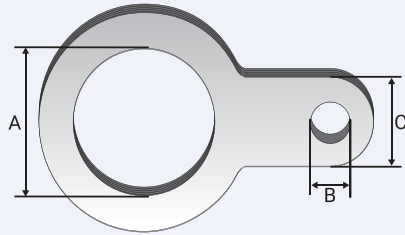

Product Code	Size Ref.	Dimension 'A'	Dimension 'B'	Dimension 'C'	Square Section	Short Circuit Fault Current Ratings BS6121 Part 5: 1993	
6220-1	0/1	M20	7mm	12mm x 1.5mm	18mm ²	20mm	3.06KA / 1 second
622902	2	M25	7mm	12mm x 1.5mm	18mm ²	25mm	4.00KA / 1 second
622903	3	M32	12mm	22mm x 1.5mm	33mm ²	32mm	5.40KA / 1 second
622904	4	M40	12mm	32mm x 1.5mm	48mm ²	40mm	7.20KA / 1 second
622905	5	M50	12mm	40mm x 1.5mm	60mm ²	50mm	10.40KA / 1 second
622906	6	M63	12mm	40mm x 1.5mm	60mm ²	63mm	10.40KA / 1 second
622907	7	M75	12mm	40mm x 1.5mm	60mm ²	75mm	10.40KA / 1 second
622908	8	M80	12mm	40mm x 1.5mm	60mm ²	-	-
622909	9	M90	12mm	40mm x 1.5mm	60mm ²	-	-

All dimensions are in mm.

Screw-On Earth Tag

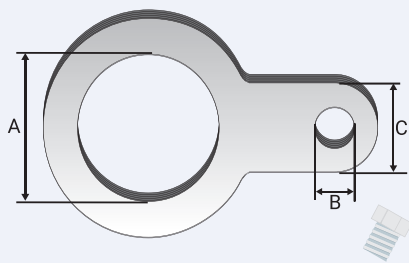

Product Code	Size Ref.	Dimension 'A'	Dimension 'B'	Dimension 'C'	Square Section	Short Circuit Fault Current Ratings BS6121 Part 5: 1993	
6030-1	0/1	M20	M6	10mm x 3mm	30mm ²	20mm	26KA / 1 second
603202	2	M25	M6	10mm x 4mm	40mm ²	25mm	26KA / 1 second
603203	3	M32	M6	12mm x 6mm	70mm ²	32mm	26KA / 1 second
603204	4	M40	M8	20mm x 6mm	120mm ²	40mm	26KA / 1 second
603205	5	M50	M10	24mm x 8mm	185mm ²	50mm	43KA / 1 second
603206	6	M63	M12	40mm x 8mm	300mm ²	63mm	43KA / 1 second
603207	7	M75	M12	40mm x 8mm	300mm ²	75mm	43KA / 1 second
603208	8	M80	M12	40mm x 8mm	300mm ²	-	-
603209	9	M90	M12	40mm x 8mm	300mm ²	-	-

All dimensions are in mm.

Sealing Gasket Metric



Product Code	Metric Size	Thickness 'A'
805520	M20	2.0
805525	M25	2.0
805532	M32	2.0
805540	M40	2.0
805550	M50	2.0
805563	M63	2.0
805575	M75	2.0
805580	M80	2.0
805590	M90	2.0

All dimensions are in mm.

Serrated Washer

STAINLESS STEEL 316/316L

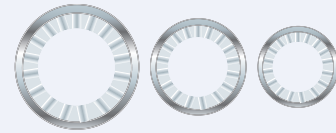

Product Code	Metric Size
805620	M20
805625	M25
805632	M32
805640	M40
805650	M50
805663	M63
805675	M75
805680	M80
805690	M90

All dimensions are in mm.

Insulation Sleeve



Product Code	Size Reference
550502	2

All dimensions are in mm.

Terminal Connector



Product Code	Size Ref.	Hole Dimeter	Allen Key No.
580302	2	10mm	4mm

All dimensions are in mm.