

## COPPER STALK LUGS

The CABAC copper stalk range are crimped with standard hexagon dies for the equivalent copper lug. The tooling is dimensionally compatible with standard Australian tooling.

Virtually any stalk variant can be manufactured to order.

### COMPLIANCE AND SAFETY

- AS4325 Part 1 Australia; IEC France; DIN/VDE Germany; JIS Japan; BS United Kingdom; UL/NEMA USA
- Accepting Authorities: Electricity Services Victoria, Energy Australia, Rail Services Australia, Energex, Western Power - and many other recognised authorities

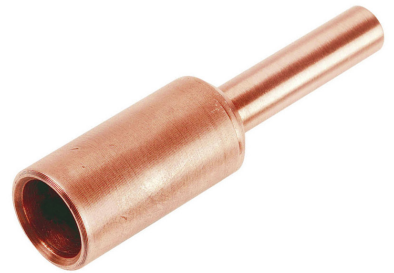

### TECHNICAL INFORMATION

	DESCRIPTION
<b>Conductive Material</b>	Copper 99.95% pure Oxygen content 30 p.p.m. Max. Tensile strength 200 MPa Ductile rating 40% Final metal state fully annealed
<b>Plating</b>	This product is not supplied plated
<b>Operating Temperature</b>	-55°C to 155°C
<b>General Electrical Properties</b>	Total conductivity 99.7% IACS Total resistivity 1.738 micro-ohm cm
<b>Dimensional Specification</b>	Tooling is interchangeable between Cable Accessories, Utilux and Burndy

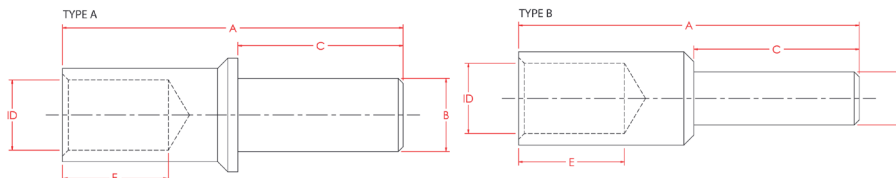

Part No.	Nominal Conductor (mm <sup>2</sup> )	ID Size (mm)	A (mm)	B (mm)	C (mm)	E (mm)	Type	Crimp Die	A/F Hex Die (mm)	No. Crimps	Unit	Qty
CS10/6	10	4.5	44	6	22	10	A	-	5.7	1	EA	1
CS10/8	10	4.5	44	8	22	10	A	-	5.7	1	EA	1
CS10/10	10	4.5	44	10	22	10	A	-	5.7	1	EA	1
CS10/12	10	4.5	44	12	22	10	A	-	5.7	1	EA	1
CS16/6	16	5.5	53	6	22	19	A	HT130-C-16	6.3	1	EA	1
CS16/8	16	5.5	53	8	22	19	A	HT130-C-16	6.3	1	EA	1
CS16/10	16	5.5	53	10	22	19	A	HT130-C-16	6.3	1	EA	1
CS16/12	16	5.5	53	12	22	19	A	HT130-C-16	6.3	1	EA	1
CS25/6	25	7.5	62	6	30	21	A	HT130-C-25	7.7	1	EA	1
CS25/8	25	7.5	67	8	35	21	A	HT130-C-25	7.7	1	EA	1

In support of our policy of continuous product improvement we reserve the right to change materials and specifications without notice. Drawings, where used, are not to scale. All dimensions are in millimetres and sizes given are approximate. Where possible, technical MSDS data sheets are made available on the website. All products should be installed and used in accordance with manufacturer's instructions provided. Warning: products may be the subject of registered designs and patents. Refer to website for terms and conditions on warranty.

## COPPER STALK LUGS

### SPECIFICATIONS AND ORDERING INFORMATION

Part No.	Nominal Conductor (mm <sup>2</sup> )	ID Size (mm)	A (mm)	B (mm)	C (mm)	E (mm)	Type	Crimp Die	A/F Hex Die (mm)	No. Crimps	Unit	Qty
CS25/10	25	7.5	67	10	35	21	A	HT130-C-25	7.7	1	EA	1
CS25/12	25	7.5	67	12	35	21	A	HT130-C-25	7.7	1	EA	1
CS35/6	35	8.5	62	6	30	21	B	HT130-C-35	9.2	1	EA	1
CS35/8	35	8.5	67	8	35	21	A	HT130-C-35	9.2	1	EA	1
CS35/10	35	8.5	67	10	35	21	A	HT130-C-35	9.2	1	EA	1
CS35/12	35	8.5	67	12	35	21	A	HT130-C-35	9.2	1	EA	1
CS50/8	50	9.5	69	8	35	22	B	HT130-C-50	10.4	1	EA	1
CS50/10	50	9.5	69	10	35	22	A	HT130-C-50	10.4	1	EA	1
CS50/12	50	9.5	69	12	35	22	A	HT130-C-50	10.4	1	EA	1
CS50/16	50	9.5	69	16	35	22	A	HT130-C-50	10.4	1	EA	1
CS70/10	70	11.5	77	10	40	24	B	HT130-C-70	11.5	1	EA	1
CS70/12	70	11.5	77	12	40	24	A	HT130-C-70	11.5	1	EA	1
CS70/16	70	11.5	77	16	40	24	A	HT130-C-70	11.5	1	EA	1
CS95/10	95	13.5	80	10	40	27	B	HT130-C-95	14.2	1	EA	1
CS95/12	95	13.5	80	12	40	27	B	HT130-C-95	14.2	1	EA	1
CS95/16	95	13.5	80	16	40	27	A	HT130-C-95	14.2	1	EA	1
CS120/10	120	15.5	82	10	40	30	B	HT130-C-120	16.5	1 FOR ROUND, 2 FOR COMPACTED	EA	1
CS120/12	120	15.5	82	12	40	30	B	HT130-C-120	16.5	1 FOR ROUND, 2 FOR COMPACTED	EA	1
CS120/16	120	15.5	82	16	40	30	B	HT130-C-120	16.5	1 FOR ROUND, 2 FOR COMPACTED	EA	1
CS150/10	150	16.5	89	10	45	30	B	HT130-C-150	18.3	1 FOR ROUND, 2 FOR COMPACTED	EA	1
CS150/12	150	16.5	89	12	45	30	B	HT130-C-150	18.3	1 FOR ROUND, 2 FOR COMPACTED	EA	1
CS150/16	150	16.5	89	16	45	30	B	HT130-C-150	18.3	1 FOR ROUND, 2 FOR COMPACTED	EA	1
CS185/10	185	18.5	92	10	45	32	B	HT130-C-185	20	1 FOR ROUND, 2 FOR COMPACTED	EA	1
CS185/12	185	18.5	92	12	45	32	B	HT130-C-185	20	1 FOR ROUND, 2 FOR COMPACTED	EA	1
CS185/16	185	18.5	92	16	45	32	B	HT130-C-185	20	1 FOR ROUND, 2 FOR COMPACTED	EA	1
CS240/16	240	21.5	103	16	50	38	B	HT130-C-240	23.1	3	EA	1
CS240/18	240	21.5	103	18	50	38	B	HT130-C-240	23.1	3	EA	1
CS240/20	240	21.5	103	20	50	38	B	HT130-C-240	23.1	3	EA	1
CS300/16	300	23.5	107	16	50	42	B	HT130-C-300	26	3	EA	1
CS300/18	300	23.5	107	18	50	42	B	HT130-C-300	26	3	EA	1
CS300/20	300	23.5	107	20	50	42	B	HT130-C-300	26	3	EA	1

In support of our policy of continuous product improvement we reserve the right to change materials and specifications without notice. Drawings, where used, are not to scale. All dimensions are in millimetres and sizes given are approximate. Where possible, technical MSDS data sheets are made available on the website. All products should be installed and used in accordance with manufacturer's instructions provided. Warning: products may be the subject of registered designs and patents. Refer to website for terms and conditions on warranty.