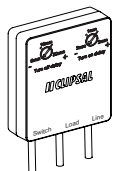
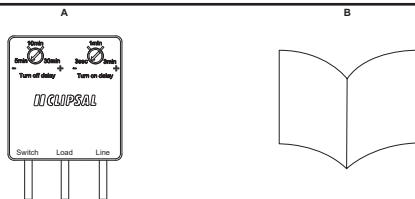
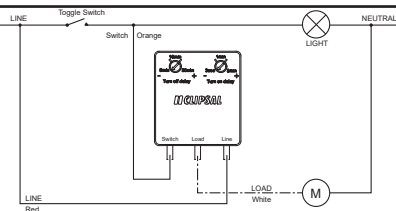
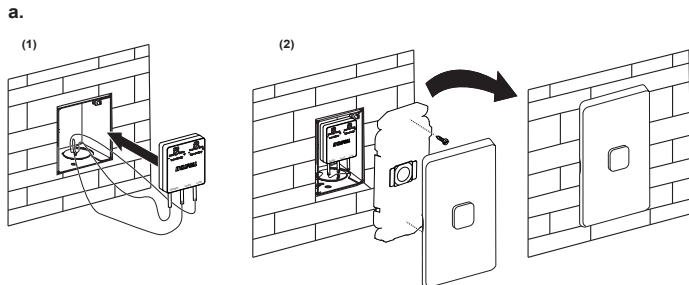

CLIPSAL

31ROFT

**1****2****3**

Run on Timer

About this product

This product is used in conjunction with a switch and an exhaust fan. When the light is switched ON/OFF it allows the exhaust fan to continue to run for a period of time. This time delay is configured during installation.

Product Range

Cat No.	Configuration
31ROFT	Run on Timer with turn off delay of 5/10/30 mins

1 Package contents

- A Run on Timer
- B Installation guide

2 Wiring diagram

Red: Line/Active; Orange: To Switch; White: To Fan Load

3 Mounting and installation

⚠ ⚠ DANGER

HAZARD OF ELECTRIC SHOCK

- This product must be installed and serviced by appropriately qualified and/or licenced electrical personnel.
- Isolate the electrical supply before doing any work on this product.
- Ensure that the product has been correctly installed and tested for safe operation before reconnecting the electrical supply.
- To comply with all safety standards, the product must be used only for the purpose described in this instruction and must be installed in accordance with the wiring rules and regulations in the location where it is installed.

Failure to follow these instructions will result in death or serious injury.

▲ CAUTION

RISK OF BURN INJURIES

During and after use, the product may be hot. Do not touch the product before it has completely cooled down.

Failure to follow these instructions can result in minor injuries or equipment damage.

Installation requirements

- Check whether the product has been damaged during transport. Do not operate/install any product which appears damaged in any way. Return the complete product to place of purchase for inspection, repair or replacement.
- Take care not to pull any electrical wires during unpacking, as this may damage the connection.
- There are no user serviceable parts inside.

a. Pre-Installation

Set the products Turn OFF delay and Turn ON delay to desired settings using trimpot adjustments on housing.

NOTE: Default settings are : Turn OFF delay - 10min ; Turn ON delay - 3sec

Turn OFF delay - this setting determines the period of time the exhaust fan will continue to run after the light switch is turned off.

Turn ON delay – this setting determines the period of time the light needs to be switched on, before the Turn OFF delay timer will be triggered and to allow the exhaust fan to run after the light switch is turned off.

b. Installation

- (1) Connect the wires as per the wiring diagram, and mount the run-on timer behind the switch plate.
- (2) Mount the switch plate to the wall.

Technical data

Parameter	31ROFT
Supply	230/240 V~ 50 Hz
Compatible Load Types	LED (Externally ballasted) : 3 - 240 VA LEDi: 3 - 240 VA
	 2.5 - 240 W
Fan Turn-ON Delay	3 seconds (default) 1 minute 3 minutes
Fan Turn-OFF Delay (run-on time)	5 minutes 10 minutes (default) 30 minutes
Switch Input type	Toggle ON/OFF
Load Switching type	Semiconductor switching device
Dimensions	39 x 42 x 12 mm
Weight	20g
IP Protection	IP30
Safety class	II
Wire length	110 mm
Ambient Operating Temperature	0 to 50°C
Ambient Storage Temperature	-10 to 70°C
Humidity	0% to 95% RH non-condensing
Fault Protection	Open circuit Overload Over temperature
Material	Flame retardant polycarbonate

Warranty Information

We warrant this product for 3 years—visit

<https://www.schneider-electric.com.au/en/about-us/legal/terms-and-conditions.jsp> for details.

Our goods also come with guarantees that cannot be excluded under the Australian Consumer Law. You are entitled to a replacement or refund for a major failure and compensation for any other reasonably foreseeable loss or damage. You are also entitled to have the goods repaired or replaced if the goods fail to be of acceptable quality and the failure does not amount to a major failure.

Schneider Electric (Australia) Pty Ltd

Customer Care: 13 73 28

33-37 Port Wakefield Road, Gepps Cross SA 5094

Email: customercare.au@schneider-electric.com

www.schneider-electric.com.au

Schneider Electric reserves the right to change specifications, modify designs and discontinue items without incurring obligation and whilst every effort is made to ensure that descriptions, specifications and other information in this instruction is correct, no warranty is given in respect thereof and the company shall not be liable for any error therein.

© Schneider Electric 2024

This material is copyright under Australian, New Zealand and international laws. Except as permitted under the relevant law, no part of this work may be reproduced by any process without prior written permission of and acknowledgement to Schneider Electric.