

HEX SCREWS



Box Qty:
50-200 varies depending on screw size.

Size = thread size x length (mm)

Size	Zinc Plated	Hot Dip Galvanised	Stainless Steel
M6x20	HS620Z A	HS620H C	HS620S C
M6x25	HS625Z A	HS625H A	HS625S C
M6x30	HS630Z A	HS630H A	HS630S C
M6x40	HS640Z A	-	HS640S C
M8x20	HS820Z A	HS820H A	HS820S A
M8x25	HS825Z A	HS825H A	HS825S A
M8x30	HS830Z A	HS830H A	HS830S A
M8x40	HS840Z A	HS840H A	HS840S A
M10x20	HS1020Z A	HS1020H A	HS1020S A
M10x25	HS1025Z A	HS1025H A	HS1025S A
M10x30	HS1030Z A	HS1030H A	HS1030S A
M10x40	HS1040Z A	HS1040H A	HS1040S A
M12x25	HS1225Z A	HS1225H A	HS1225S A
M12x30	HS1230Z A	HS1230H A	HS1230S A
M12x40	HS1240Z A	HS1240H A	HS1240S A
M12x50	HS1250Z A	HS1250H A	HS1250S C

HEX NUTS



Box Qty:
50-2000 varies depending on nut size.

Threaded Size	Zinc Plated	Hot Dip Galvanised	Stainless Steel
M6	HN6Z A	HN6H A	HN6S A
M8	HN8Z A	HN8H A	HN8S C
M10	HN10Z A	HN10H A	HN10S A
M12	HN12Z A	HN12H A	HN12S A
M16	HN16Z C	HN16H C	HN16S C

WEDGE NUTS



Box Qty:
100

Thread Size	Zinc Plated	Stainless Steel
M6	WN6Z C	-
M8	WN8Z C	-
M10	WN10Z C	WN10S C

FLAT WASHERS

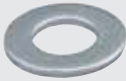

Box Qty:
100-500 varies depending on thread size.

Threaded Size	Zinc Plated	Hot Dip Galvanised	Stainless Steel
M6	FW6Z A	FW6H A	FW6S A
M8	FW8Z A	FW8H A	FW8S A
M10	FW10Z A	FW10H A	FW10S A
M12	FW12Z A	FW12H A	FW12S A
M16	FW16Z C	FW16H C	FW16S C

EZYSTRUT SPLICE COUNTERBORE NUT

Pack Qty:
100



Thread Size	Zinc Plated	Hot Dip Galvanised	Stainless Steel
M10	CNZ C	CNH A	CNS A

SPRING WASHERS



Box Qty:
100-200 varies depending on thread size.

Threaded Size	Zinc Plated	Hot Dip Galvanised	Stainless Steel
M6	SW6Z A	SW6H A	SW6S A
M8	SW8Z A	SW8H A	SW8S A
M10	SW10Z A	SW10H A	SW10S A
M12	SW12Z A	SW12H A	SW12S A
M16	SW16Z C	SW16H C	SW16S C

EZYSTRUT SPLICE BOLT

Pack Qty:
100



Thread Size	Zinc Plated	Hot Dip Galvanised	Stainless Steel
M10	SBZ C	SBH A	SBS A

Service Guide Key: A Usually in stock at all branches

C Normal lead time

B Usually in stock at head office

D Made to Order (lead time on enquiry)

THREADED ROD

■ Ask us about
Rod Cutters



Supplied in 3m lengths

Threaded Size	Zinc Plated	Hot Dip Galvanised	Stainless Steel
M6	TR6Z A	-	-
M8	TR8Z A	TR8H A	TR8S C
M10	TR10Z A	TR10H A	TR10S A
M12	TR12Z A	TR12H A	TR12S A
M16	TR16Z C	TR16H C	TR16S C

CHANNEL NUT, LONG SPRING

Box Qty: **100**

Suits 41mm high channel.
Suits all 41mm wide channel.



Threaded Size	Zinc Plated	Hot Dip Galvanised	Stainless Steel
M6	E1006Z A	E1006H A	E1006S A
M8	E1007Z A	E1007H A	E1007S A
M10	E1008Z A	E1008H A	E1008S A
M12	E1010Z A	E1010H A	E1010S A

MUD GUARD WASHERS



Box Qty:
100-200 varies depending on thread size.

Outside diameter 31mm

Threaded Size	Zinc Plated	Hot Dip Galvanised	Stainless Steel
M6	MW6Z A	MW6H A	MW6S C
M8	MW8Z A	MW8H A	MW8S C
M10	MW10Z A	MW10H A	MW10S C
M12	MW12Z A	MW12H A	MW12S C

CHANNEL NUT, SHORT SPRING

Box Qty: **100**

Suits 21mm high channel.
Suits all 41mm wide channel.



Thread Size	Zinc Plated	Hot Dip Galvanised
M6	E4006Z A	E4006H A
M8	E4007Z A	E4007H A
M10	E4008Z A	E4008H A
M12	E4010Z A	E4010H A

PAN HEAD SCREWS



Box Qty:
100-200 varies depending on screw size.

Size = thread size x length (mm)

Size	Zinc Plated	Stainless Steel
M6x16	PS616Z A	PS616S C
M6x20	PS620Z A	PS620S C
M6x25	PS625Z A	PS625S A
M8x25	PS825Z A	-

CHANNEL NUT, NO SPRING

Box Qty: **100**

Suits all 41mm wide channel



Thread Size	Zinc Plated	Hot Dip Galvanised
M6	E3006Z A	E3006H A
M8	E3007Z A	E3007H A
M10	E3008Z A	E3008H A
M12	E3010Z A	E3010H A

COUNTERSUNK PHILLIPS SCREW

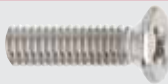

Box Qty:
100-200 varies depending on screw size.

Size = thread size x length (mm)

Size	Zinc Plated	Stainless Steel
M6x16	CS616Z A	CS616S C
M6x20	CS620Z A	CS620S C
M6x25	CS625Z A	CS625S C
M8x20	CS820Z C	CS820S C
M8x25	CS825Z C	CS825S C

E3016 CHANNEL NUT, NO SPRING

Box Qty: **100**

Suits all channel



Thread Size	Zinc Plated	Hot Dip Galvanised	Stainless Steel
M6	E3016Z A	E3016H A	E3016S A

FASTENERS

STRUT SYSTEMS

CABLE SUPPORTS

FIRERATED

PIPE SUPPORTS

SLEEVE ANCHOR - HEX HEAD



Box Qty:
25-100 varies depending on screw size.

Size = thread size x length (mm)

Size	Zinc Plated	Hot Dip Galvanised	Stainless Steel
M8x40	DB840Z C	DB840H C	DB840S C
M8x60	-	-	DB860S C
M8x65	DB865Z C	DB865H C	-
M8x80	-	-	DB880S C
M8x85	DB885Z C	DB885H C	-
M10x50	DB1050Z C	DB1050H C	DB1050S C
M10x60	DB1060Z C	DB1060H C	-
M10x75	DB1075Z C	DB1075H C	DB1075S C
M10x100	DB10100Z C	DB10100H C	DB10100S C
M12x60	DB1260Z C	DB1260H C	DB1260S C
M12x75	DB1275Z C	DB1275H C	DB1275S C
M12x100	DB12100Z C	DB12100H C	DB12100S C

SLEEVE ANCHOR - FLUSH HEAD



Box Qty:
25-50 varies depending on screw size.

Zinc Yellow Passivate
Size = thread size x length (mm)

Size	Part Number	Service Guide
M10x55	FHS1055	C
M10x100	FHS10100	C
M12x80	FHS1280	C

THROUGH BOLT



Box Qty:
25-50 varies depending on screw size.

Galvanised (Grade 5.8)
Size = thread size x length (mm)

Size	Part Number	Service Guide
M8x80	PTBG08080	C
M8x100	PTBG08100	C
M8x120	PTBG08120	C
M10x90	PTBG10090	C
M10x120	PTBG10120	C
M12x80	PTBG12080	C
M12x100	PTBG12100	C
M12x140	PTBG12140	C

THROUGH BOLT - PTB-ETA1-PRO



Box Qty:
25-100 varies depending on screw size.



Zinc Clear
Size = thread size x length (mm)

Size	Part Number	Service Guide
M8x85	69308-PWR	C
M8x105	69314-PWR	C
M8x130	69318-PWR	C
M10x90	69334-PWR	C
M10x120	69340-PWR	C
M12x90	69358-PWR	C
M12x100	69360-PWR	C
M12x135	69366-PWR	C
M12x185	69372-PWR	C

THROUGH BOLT - PTB-SS-ETA1-PRO



Box Qty:
25-200 varies depending on screw size.

Stainless Steel (316)
Size = thread size x length (mm)

Size	Part Number	Service Guide
M8x50*	07802-PWR	C
M8x65	07804-PWR	C
M8x75	07806-PWR	C
M8x85	07807-PWR	C
M8x95	07808-PWR	C
M8x105	07810-PWR	C
M8x120	07812-PWR	C
M8x130	07814-PWR	C
M10x60*	07820-PWR	C
M10x80*	07822-PWR	C
M10x85	07824-PWR	C
M10x90	07826-PWR	C
M10x100	07828-PWR	C
M10x110	07829-PWR	C
M10x130	07830-PWR	C
M10x160	07831-PWR	C
M10x180	07832-PWR	C
M12x80*	07834-PWR	C
M12x100	07836-PWR	C
M12x125	07838-PWR	C
M12x135	07840-PWR	C

*Are not ETA approved.

Service Guide Key: **A** Usually in stock at all branches

C Normal lead time

B Usually in stock at head office

D Made to Order (lead time on enquiry)

SCREW BOLT - BLUE TIP (ETA1)

Fire Rated



Box Qty:
20-50 varies depending on screw size.

Zinc Clear

Size = thread size x length (mm)

Size	Part Number	Service Guide
M10x60	27045-PWR	C
M10x75	27050-PWR	C
M10x100	27055-PWR	C
M10x110	27046-PWR	C
M10x120	27060-PWR	C
M10x140	27048-PWR	C
M10x160	27052-PWR	C
M10x200	27054-PWR	C
M10x240	27056-PWR	C
M10x280	27058-PWR	C
M12x75	27065-PWR	C
M12x100	27070-PWR	C
M12x150	27075-PWR	C
M12x200	27064-PWR	C

THREADED ROD HANGER (CONCRETE SCREW ADAPTOR)

Fire Rated



Box Qty: 50

Zinc

Size = internal thread

Size	Description	Part Number	Service Guide
M8-M10	6 x 35mm	MUMMCSI05540603	C
	6 x 55mm	MUMMCSI05540605	C

HEX HEAD CONCRETE SCREW



Box Qty: 100
Perma-Seal™

Size	Description	Part Number	Service Guide
3/16"	4.8 x 32mm	02700-PWR	C
	4.8 x 45mm	02702-PWR	C
	4.8 x 58mm	02704-PWR	C
	6.5 x 70mm	02706-PWR	C
	6.5 x 83mm	02708-PWR	C
	6.5 x 95mm	02710-PWR	C
	6.5 x 100mm	02712-PWR	C

INSTALLATION TOOL - SDS DRILL BIT



Box Qty: 1

Size	Drive	Part Number	Service Guide
5/32"	SDS Plus	2796SD-PWR	C

SCREW BOLT - BLUE TIP



Box Qty:
20-50 varies depending on screw size.

Size = thread size x length (mm)

Size	Zinc (Yellow)	Hot Dip Galvanised
M8x50	BT0850Z C	BT0850H C
M10x60	BT1060Z C	BT1060H C
M10x100	BT10100Z C	BT10100H C
M12x100	BT12100Z C	BT12100H C
M12x150	BT12150Z C	BT12150H C

WALL DOG™



Powers' Wall Dog™ is a one-piece screw anchor without the need for plugs.

Zinc Clear

Box Qty: 100

Length	Drive	Part Number	Service Guide
32mm	PH2	02316-PWR	C

SNAKE-PRO™

Fire Rated



Powers' Snake-Pro is an internally threaded self-tapping anchor.

Box Qty: 50

Zinc Clear

Size	Part Number	Service Guide
M8	SM8PRO-PWR	C
M10	SM10PRO-PWR	C

INSTALLATION TOOL - SDS PLUS DRILL BIT



Box Qty: 1

Size	Part Number	Service Guide
12.7	SB12.7x50-PWR	C

INSTALLATION TOOL - SETTING TOOL



Box Qty: 1

Size	Part Number	Service Guide
M8	SSTM8-PWR	C
M10	SSTM10-PWR	C

SNAKE-PRO™ BULK BUCKET

Includes 500pcs, 2 x drill bits and 1 x setting tool.

Size	Part Number	Service Guide
M10	SM10KIT-PWR	C

DROP-IN ANCHOR



Box Qty: **100**

Size	Zinc (Clear)	Stainless Steel (316)
M6	24600-PWR C	06224-PWR C
M8	24602-PWR C	06225-PWR C
M10	24604-PWR C	06226-PWR C
M12	24606-PWR C	06228-PWR C

INSTALLATION TOOL - MANUAL SETTING TOOL



Box Qty: **1**

Size	Part Number	Service Guide
M6	06330-PWR	C
M8	06332-PWR	C
M10	06334-PWR	C
M12	06336-PWR	C

LIPPED DROP-IN ANCHOR*



Box Qty: **50**
Zinc

*Does not carry ETA approvals.

Size	Part Number	Service Guide
M10	LPD1030Z	A
	LPD1040Z	A
M12	LPD1250Z	A

LIPPED DROPIN ANCHOR BUCKET*



Description	Part Number
M10x30mm (500pcs), 2 x drill bits, 1 x setting tool.	LDA1030B C

INSTALLATION TOOLS for M10x30mm*



Box Qty: **1**

Description	Part Number	Service Guide
Setting Tool	LDSP1030-PWR	C
SDS Drill Bit	SDSPLUS12x35-PWR	C

INSTALLATION TOOL - MANUAL SETTING TOOL*



Box Qty: **1**

Size	Part Number	Service Guide
M10	LDST10-PWR	C

ETA LIPPED-PRO DROP-IN ANCHOR



Box Qty: **100**
Zinc (Clear)

Size	Part Number	Service Guide
M6	06304-PWR	C
M8	06305-PWR	C
M10	06306-PWR	C
M12	06308-PWR	C

LIPPED DROPIN ANCHOR BUCKET



Description	Part Number
M10x40mm (500pcs), 2 x drill bits, 1 x setting tool.	LDA1040B C
M12x50mm (300pcs), 2 x drill bits, 1 x setting tool.	LDA1050B C

INSTALLATION TOOL - MANUAL SETTING TOOL



Box Qty: **1**

Size	Part Number	Service Guide
M6	06330-PWR	C
M8	06332-PWR	C
M10	06334-PWR	C
M12	06336-PWR	C

BANG-IT™ CAST-IN ROD HANGER



Box Qty: **100**
Zinc Yellow

Size	Colour	Part Number	Service Guide
M10	Green	28160-PWR	C
M12	Yellow	28170-PWR	C

WOOD-KNOCKER™ CAST-IN ROD HANGER



Box Qty: **200**
Zinc Yellow

Size	Colour	Part Number	Service Guide
M10	Green	28210-PWR	C
M12	Yellow	28220-PWR	C

Service Guide Key: A Usually in stock at all branches

C Normal lead time

B Usually in stock at head office

D Made to Order (lead time on enquiry)

HANGER MATE™ INTERNAL THREADED ROD HANGERS



Installation tools are also available.

Box Qty: **100**
Zinc Clear

Size	Description	Part Number	Service Guide
M10	6x40mm	HM6M1040-PWR	C
M12	8x50mm	HM8M1250-PWR	A

CONCRETE STUD SCREW



Box Qty: **25**
Stainless Steel

Size	Description	Part No.	Service Guide
M12	10x160mm	5929261080	C

THREADED ROD HANGER INSTALLATION TOOLS



Quick-Drive SDS Drill Bit

Box Qty: **1**



Quick Drive Sleeve



Socket Driver

Description	Size	Part No.
Quick-Drive SDS Drill Bit	1/4"	05866-PWR C
Quick Drive Sleeve	1/4"	5866-PWR C
Socket Driver (Blue)	M10	7197-PWR C

VERTICAL THREADED ROD HANGER (FOR TIMBER)



Box Qty: **100**
Zinc Clear

Size	Length	Part Number	Service Guide
M10	25mm	28125	C
	50mm	28044	C

VERTICAL THREADED ROD HANGER (FOR STEEL)



Box Qty: **100**
Zinc Clear

Size	Length	Part Number	Service Guide
M10	25mm	28008	C

SIDE THREADED ROD HANGER (FOR STEEL)



Box Qty: **100**
Zinc Clear

Size	Length	Part Number	Service Guide
M10	25	28100	C

THREADED ROD HANGER (FOR CONCRETE)



Box Qty: **100**
Zinc Clear

Size	Length	Part Number	Service Guide
M10	38mm	28084	C

THREADED ROD HANGER BUCKET

Includes 500pcs, 3 x drill bits, 1 x socket driver, and 1 x setting tool sleeve.

Size	Part Number	Service Guide
M10	28084B	C

Can't find what you need?

We have a fixings, fasteners and consumables catalogue with more details and range of products available.

Request a copy from your representative or download from our website.