

Maxi Master Gen II LED Floodlight

MML200A

- Weather protection IP65
- Diecast aluminium body powder coated black
- Lightweight for easy installation



Performance

System Power	200W
Exit Lumen	22000lm
Efficacy	110lm/W
CCT	4000K
CRI	80
Operating Temperature	0°C to 40°C
MacAdam Steps	7SDCM
Ingress Protection Rating	IP65
Impact Rating	IK08
Beam Distribution	Asymmetric
Beam Angle	60°
Warranty	5 Years
Lifetime	50,000hrs (L70/B50)

Physical

Dimensions	L380 x W342 x H60mm
Diffuser	Glass Borosilcate
Luminaire Colour	Black
Weight	6kg
Luminaire Material	Aluminium (Die Cast)
Heatsink	Aluminium (Die Cast)
Finish	Powder Coated
Installation	Trunnion

Electrical

Dimming	Non - Dimmable
Voltage	240V
Line Voltage Frequency	50Hz/60Hz
Inrush Current	40A
Inrush Current Duration	900µs
Electrical Rating	Class 1

Line Drawings

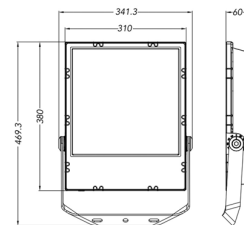

Product Images



Accessories

MML50WG	MML50 WIRE GUARD STAINLESS STEEL POWDERCOATED BLACK
MML100WG	MML100 WIRE GUARD STAINLESS STEEL POWDERCOATED BLACK
MML200WG	MML200 WIRE GUARD STAINLESS STEEL POWDERCOATED BLACK
MML300WG	MML300 WIRE GUARD STAINLESS STEEL POWDERCOATED BLACK

Line Drawings

MAXI Master LED Flood GEN II Trunking Mounting Details.

1. 10W/200W Mounting Detail:

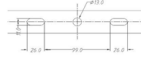

2. 200W Mounting Detail:



3. 300W Mounting Detail:

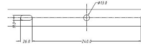

02/2021