



## UTILUX SOLID PALM COPPER CRIMP LUGS CG SD TYPE

### KEY FEATURES

- Specially made for overhead connections for electrical distribution systems
- Use where vibration is a concern on railway electrification systems
- Range of 6 - 95mm<sup>2</sup>
- Solid palm eliminates the ingress of moisture
- Electro-tinned

Utilux is a brand that has built an enviable reputation for high quality, reliable electrical connectors. For over 90 years, this dynamic Australian brand has been a leader in the field of interconnection systems.

Our aim is to provide the best possible products and services to keep our customers at the cutting edge of industry standards - internationally.

You can be sure that Utilux branded products are fabricated from the finest materials and produced to exacting tolerances. They represent the latest technology and the best design for the tasks they are required to perform.

Utilux is a leading brand of electrical connectors sold to original equipment manufacturers and electrical distribution companies throughout Australia, New Zealand and Asia. A comprehensive range, the most up to date production technology and the highest quality control standards ensure that there are Utilux connectors, of optimum reliability and durability, for all major power distribution applications.

As part of the worlds largest electrical connector company, TE Connectivity, the development of products is an ongoing commitment. It is done on a global basis, utilising the talents of many people throughout the organisation to ensure a global product for a local market.

**Customers can count on consistent, high quality products, driven by TE's proven innovation and backed by our extraordinary customer support.**

## UTILUX SOLID PALM COPPER CRIMP LUGS



Utilux have introduced a range of small copper lugs to be used in heavy industry. The range of connectors (6mm<sup>2</sup> to 35mm<sup>2</sup>) compliments the existing larger size copper cast lugs. The lugs are fabricated from copper rod to maximise the strength. They are made without a seam in the palm, with an increased wall thickness and electro-tinned plated. The solid palm also eliminates the ingress of moisture which makes them suitable for outdoor use. Crimping has been rationalised so that only four sets of dies are required to terminate the full range of lugs.

PRODUCT SELECTION INFORMATION											
Catalogue Number	Conductor Area (mm <sup>2</sup> )	Stud Size	Dimensions (mm)								Crimping Die
			A	B	C	D	E	F	G		
CG6SDM6	6	M6	51	16	4.2	21	-	23	4.5	38-77CU	
CG6SDM8		M8	51	16	4.2	21	-	23	4.5	38-77CU	
CG6SDM10		M10	51	16	4.2	21	-	23	4.5	38-77CU	
CG10SDM6	10	M6	51	16	4.2	21	-	23	4.8	38-77CU	
CG10SDM8		M8	51	16	4.2	21	-	23	4.8	38-77CU	
CG10SDM10		M10	51	16	4.2	21	-	23	4.8	38-77CU	
CG16SDM8	16	M8	51	16	4.2	21	-	23	5.5	38-77CU	
CG16SDM10		M10	51	16	4.2	21	-	23	5.5	38-77CU	
CG16SDM12		M12	51	16	4.2	21	-	23	5.5	38-77CU	
CG25SDM10	25	M10	72	23	4.5	29	-	27	7.1	38-104CU	
CG25SDM12		M12	72	23	4.5	29	-	27	7.1	38-104CU	
CG35LPSDM6-18	35	M6	72	23	4.5	40	18	23	8.5	38-104CU	
CG35SDM10		M10	72	23	4.5	29	-	30	8.5	38-104CU	
CG35SDM12		M12	72	23	4.5	29	-	30	8.5	38-104CU	
CG70SDM10	25	M10	78	25	8	30	-	27	11	38-130CU	
CG70SDM12		M12	78	25	8	30	-	27	11	38-130CU	
CG95SDM10	35	M10	78	26	8	30	-	27	13.4	38-142CU	
CG95SDM12		M12	78	26	8	30	-	27	13.4	38-142CU	

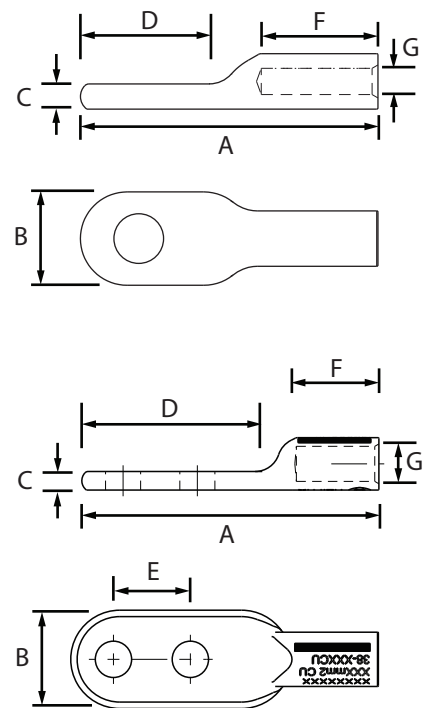

[te.com/energy](http://te.com/energy)

©2016 TE Connectivity Ltd. family of companies. All Rights Reserved. EPP-2487-DDS6-AU Rev2

Utilux, TE Connectivity and TE Connectivity (logo) are trademarks. Other logos, product and/or company names might be trademarks of their respective owners. While TE has made every reasonable effort to ensure the accuracy of the information in this brochure, TE does not guarantee that it is error-free, nor does TE make any other representation, warranty or guarantee that the information is accurate, correct, reliable or current. TE reserves the right to make any adjustments to the information contained herein at any time without notice. TE expressly disclaims all implied warranties regarding the information contained herein, including, but not limited to, any implied warranties of merchantability or fitness for a particular purpose. The dimensions in this catalog are for reference purposes only and are subject to change without notice. Specifications are subject to change without notice. Consult TE for the latest dimensions and design specifications.

### FOR MORE INFORMATION: TE Customer Support Centers

NSW/QLD/NT/ACT: +61 (2) 9554 2695  
VIC/TAS/SA: +61 (3) 9271 5243  
WA: +61 (8) 9358 7806  
New Zealand: +64 (9) 634 4580