



### Copper Cable Lug

#### Copper Lug Series

Copper cable lugs are used to terminate the ends of battery cable and welding cable so they can be connected to other electrical equipment such as starters, fuse blocks, distribution blocks, etc. Cable lugs are highly conductive and can handle very high currents. Our range of Copper Lugs/Links complies to Australian & New Zealand standard AS/NZS4325 Part 1:1995.

#### Features and Benefits

- Heat cycle certification available on request
- Wide range of sizes
- Can be crimped using cable lug crimper or hammer style crimper
- Easy insertion of cable



Copper Lug Series.



Long Barrel Short Palm Series



Long Barrel Long Palm Series



Bell Mouth Copper Lug Series



Bimetal Series

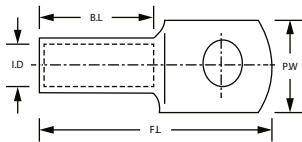

<b>MATERIAL</b>	Copper Grade C11000
<b>Conductive Material</b>	Copper 99.9% pure Oxygen content 30 p.p.m Max. Tensile strength 205 Mpa Min Ductile rating 40% Final metal state fully annealed Electroplating material tin 99.9% pure Other metals lead + antimony Thickness 5 -10 microns
<b>Conformant Standards</b>	AS/NZS4325 Part 1:1995
<b>General Electrical Properties</b>	Total conductivity 99.9% IACS Total resistivity: 1.72 micro-ohm cm
<b>Operating Temperature</b>	-55°C to 155°C due to oxygen-free copper

### COPPER LUGS



HTAU PART NO.	Conductor Size (mm <sup>2</sup> )	Stranding metric	Stud	ID Size	Palm Width	Barrel Length	Full Length	A/F Hex	Pack Qty
CL1.5-4	1.5	7/0.50	M4	1.8	8	7	18	-	100
CL1.5-5			M5		8	7	18		
CL1.5-6			M6		10	7	19		

All dimensions in mm. Subject to technical changes.

Note: Copper lugs 95mm<sup>2</sup> and larger are available in single pack.





HTAU PART NO.	Conductor Size (mm <sup>2</sup> )	Stranding metric	Stud	ID Size	Palm Width	Barrel Length	Full Length	A/F Hex	Pack Qty	
CL2.5-4	2.5	7/0.67	M4	2.4	8	8	19	-	100	
CL2.5-5			M5		8		19			
CL2.5-6			M6		10		21			
CL2.5-8			M8		12	7	24			
CL4-5	4	7/0.85	M5	3.1	10	9	22	-	100	
CL4-6			M6		12		27			
CL4-8			M8		10	27				
CL4-10			M10			32				
CL6-5	6	7/1.04	M5	3.8	10	9	23	4.4	100	
CL6-6			M6		12		27			
CL6-8			M8		10	27				
CL6-10			M10			32				
CL10-5			M5			15	32			
CL10-6	10	7/1.35	M6	4.7	12	10	27	5.7	100	
CL10-8			M8		14		29			
CL10-10			M10		15		32			
CL10-12			M12		18	11	38			
CL16-6	16	7/1.70	M6	5.5	11	19	39	6.3	50	
CL16-8			M8		14		41			
CL16-10			M10		16		46			
CL16-12			M12		18		46			
CL25-6	25	19/1.35	M6	7.1	13.5	21	41	7.7	50	
CL25-8			M8				44			
CL25-10			M10		16		48			
CL25-12			M12		18		48			
CL35-6	35	19/1.53	M6	8.4	16	21	45	9.2	50	
CL35-8			M8				18			51
CL35-10			M10		20		22			51
CL35-12			M12		22		51			
CL50-6	50	19/1.78	M6	9.5	18	22	46	10.4	50	
CL50-8			M8				46			
CL50-10			M10		21		22			52
CL50-12			M12		21		22			52
CL70-6	70	19/2.14	M6	11.3	21	24	54	11.5	25	
CL70-8			M8							
CL70-10			M10							
CL70-12			M12							
CL70-16			M16							
CL95-8	95	37/1.78	M8	13.5	25	27	60	14.2	25	
CL95-10			M10				64			
CL95-12			M12				64			
CL95-16			M16				64			
CL120-8	120	37/2.03	M8	15.6	30	30	64	16.5	25	
CL120-10			M10				70			
CL120-12			M12				70			
CL120-16			M16				70			

All dimensions in mm. Subject to technical changes.  
Note: Copper lugs 95mm<sup>2</sup> and larger are available in single pack.





HTAU PART NO.	Conductor Size (mm <sup>2</sup> )	Stranding metric	Stud	ID Size	Palm Width	Barrel Length	Full Length	A/F Hex	Pack Qty
CL150-10	150	37/2.25	M10	16.7	32	30	71	18.3	20
CL150-12			M12				75		
CL150-16			M16						
CL150-B			Blank				1		
CL185-10	185	37/2.52	M10	18.4	36	32	74	20	20
CL185-12			M12				79		
CL185-16			M16						
CL240-10	240	61/2.25	M10	21.2	41	38	92	23.1	10
CL240-12			M12						
CL240-16			M16						
CL240-B			Blank						
CL300-10	300	61/2.52	M10	23.8	46	42	101	26	5
CL300-12			M12						
CL300-16			M16						
CL300-B			Blank						
CL400-12	400	61/2.85	M12	26.8	50	44	114	28.1	1
CL400-16			M16						
CL400B			Blank						
CL500-10	500	61/3.20	M10	30	56	50	119	31	1
CL500-12			M12						
CL500B			Blank						
CL630-12	630	127/2.52	M12	34	64.4	58	139	37	1
CL630-16			M16						
CL630B			Blank						

All dimensions in mm. Subject to technical changes.

Note: Copper lugs 95mm<sup>2</sup> and larger are available in single pack.

## LONG BARREL SHORT PALM



HTAU PART NO.	Conductor Size (mm <sup>2</sup> )	Stud	ID Size	Palm Width	Barrel Length	Full Length	A/F Hex	Pack Qty
CL16-6LB	16	M6	5.5	11	35	60	6.3	1
CL16-8LB		M8		14				1
CL25-8LB	25	M8	7.1	13.5		62	7.7	1
CL35-10LB	35	M10	8.4	18	44	65	9.2	1
CL35-12LB	35	M12		20				1
CL50-10LB	50	M10	9.5	18		77	10.4	1
CL70-10LB	70	M10	11.3	21	48	81	11.5	1
CL70-12LB		M12		21				1
CL95-10LB	95	M10	13.5	25	54	88	14.2	1
CL95-12LB		M12						1
CL120-10LB	120	M10	15.6	20.6	60	98	16.5	1
CL120-12LB		M12						1
CL150-12LB	150	M12	16.7	22.2		110	18.3	1
CL630LB	630	Blank	34.00	64.4	115	193	37	1

All dimensions in mm. Subject to technical changes.



LONG BARREL LONG PALM



PART NO.	Conductor Size (mm <sup>2</sup> )	ID Size	Palm Width	Barrel Length	Full Length	A/F Hex	Pack Qty
CL16LPB	16	5.5	18.0	21	82	6.3	1
CL25LPB	25	7.1	18.0	29	95	7.7	1
CL35LPB	35	8.4	20.0	35	112	9.2	1
CL50LPB	50	9.5	21.0	44	130	10.4	1
CL70LPB	70	11.3	26.0	48	154	11.5	1
CL95LPB	95	13.5	26.0	54	161	14.2	1
CL120LPB	120	15.6	30.0	60	168	16.5	1
CL150LPB	150	16.7	32.0	60	169	18.3	1
CL185LPB	185	18.4	36.0	64	174	20	1
CL240LPB	240	21.2	41.0	80	180	23.1	1
CL300LPB	300	23.8	46.0	90	190	26	1
CL400LPB	400	26.8	50.0	100	200	28.1	1
CL500LPB	500	30.0	56.0	105	205	31	1
CL630LPB	630	34.0	64.4	115	215	37	1

All dimensions in mm. Subject to technical changes.

BELL MOUTH COPPER LUGS



PART NO.	Conductor Size (mm <sup>2</sup> )	Stud	ID Size	Palm Width	Barrel Length	Full Length	A/F Hex	Pack Qty	
CL10-5BM	10	M5	4.7	12	10	27	5.7	100	
CL10-6BM		M6		14		11			29
CL10-8BM		M8							32
CL10-10BM		M10							38
CL10-12BM		M12		18	11	38			
CL16-6BM	16	M6	5.5	11	19	39	6.3	50	
CL16-8BM		M8		14		41			
CL16-10BM		M10		16		46			
CL16-12BM		M12		18		46			
CL25-6BM	25	M6	7.1	13.5	21	41	7.7	50	
CL25-8BM		M8		16		21			44
CL25-10BM		M10							48
CL25-12BM		M12							18
CL35-6BM	35	M6	8.4	15	21	41	9.2	50	
CL35-8BM		M8							
CL35-10BM		M10							
CL35-12BM		M12							
CL50-6BM	50	M6	9.5	15	22	46	10.4	50	
CL50-8BM		M8		19		49			
CL50-10BM		M10		21		54			
CL50-12BM		M12							
CL70-6BM	70	M6	11.3	17	24	45	11.5	25	
CL70-8BM		M8		19		24			51
CL70-10BM		M10							
CL70-12BM		M12							
CL70-16BM		M16							

All dimensions in mm. Subject to technical changes.



PART NO.	Conductor Size (mm <sup>2</sup> )	Stud	ID Size	Palm Width	Barrel Length	Full Length	A/F Hex	Pack Qty
CL95-8BM	95	M8	13.5	19	27	51	14.2	25
CL95-10BM		M10				55		
CL95-12BM		M12				55		
CL120-10BM	120	M10	15.6	19	30	61	16.5	25
CL120-12BM		M12						
CL120-16BM		M16						
CL150-10BM	150	M10	16.7	19	30	66	18.3	20
CL150-12BM		M12				75		
CL185-10BM	185	M10	18.4	24.5	32	74	20	20
CL185-12BM		M12				79		
CL240-10BM	240	M10	21.2	31	38	82	23.1	10
CL240-12BM		M12						
CL240-16BM	300	M16	23.8	31	42	81	26	5

All dimensions in mm. Subject to technical changes.

Note: Bell mouth lugs from 95mm<sup>2</sup> are available in each.

### BELL MOUTH CIRCUIT BREAKER LUGS NARROW PALM



PART NO.	Conductor Size (mm <sup>2</sup> )	Stud	ID Size	Palm Width	Barrel Length	Full Length	A/F Hex	Pack Qty
CLB35-6	35	M6	8.4	15	21	41	9.2	50
CLB50-6	50	M6	9.5	15	22	43	10.4	50
CLB50-10		M10		19		44		
CLB70-6	70	M6	11.3	17	24	55	11.5	25
CLB70-10		M10		19		51		
CLB95-8	95	M8	13.5	19	27	51	14.2	25
CLB95-10		M10						
CLB120-8	120	M8	15.6	19	30	61	16.5	25
CLB120-10		M10						
CLB150-10	150	M10	16.7	19	30	66	18.3	20
CLB185-10	185	M10	18.4	24.5	32	74	20	20
CLB240-10	240	M10	21.2	28.5	38	82	23.1	10
CLB240-12		M12						
CLB300-10	300	M10	23.8	31	42	81	26	5

All dimensions in mm. Subject to technical changes.

Note: Bell mouth circuit breaker lugs from 95mm<sup>2</sup> are available in each.

### COPPER CRIMP LINKS



PART NO.	Conductor Size (mm <sup>2</sup> )	Stranding metric	ID Size	Full Length	A/F Hex	Pack Qty
CS1.5	1.5	1/0.50	1.8	22	-	100
CS2.5	2.5	7/0.67	2.4	22	-	100
CS4	4	7/0.85	3.1	22	-	100
CS6	6	7/1.04	3.8	22	4.4	100
CS10	10	7/1.35	4.7	22	5.7	100

All dimensions in mm. Subject to technical changes.



PART NO.	Conductor Size (mm <sup>2</sup> )	Stranding metric	ID Size	Full Length	A/F Hex	Pack Qty
CS16	16	7/1.70	5.5	44	6.3	50
CS25	25	19/1.35	7.1	47	7.7	50
CS35	35	19/1.53	8.4	47	9.2	50
CS50	50	19/1.78	9.5	47	10.4	50
CS70	70	19/2.14	11.3	50	11.5	25
CS95	95	37/1.78	13.4	54	14.2	25
CS120	120	37/2.03	15.6	65	16.5	25
CS150	150	37/2.25	16.7	65	18.3	20
CS185	185	37/2.52	18.4	65	20	20
CS240	240	61/2.25	21.2	90	23.1	10
CS300	300	61/2.52	23.8	90	26	5
CS400	400	61/2.82	26.8	90	28.1	1
CS500	500	61/3.20	30	112	30.1	1
CS630	630	127/2.52	34	112	34	1

All dimensions in mm. Subject to technical changes.  
 Note: Copper crimp links from 95mm<sup>2</sup> are available in each.

## BI-METAL



PART NO.	Conductor Size (mm <sup>2</sup> )	Stud	ID Size	Palm Width	Barrel Length	Full Length	A/F Hex	Pack Qty				
BML16-10	16	10	5.5	20	32	75	9	1				
BML25-10	25	10	7.5					1				
BML25-12		12	7.5					1				
BML35-10	35	10	8.5					1				
BML35-12		12	8.5	1								
BML50-10	50	10	9.5	24			60	115	17.3	1		
BML50-12		12	9.5							1		
BML70-10	70	10	11.5							1		
BML70-12		12	11.5		1							
BML95-10	95	10	13.5	30	60	115			17.3	1		
BML95-12		12	13.5							1		
BML120-10	120	10	15.5							1		
BML120-12		12	15.5							1		
BML150-10	150	10	16.5	35					60	120	22	1
BML150-12		12	16.5									1
BML185-10	185	10	18.5									1
BML185-12		12	18.5									1
BML240-10	240	10	22	36			60	135			28.4	1
BML240-12		12	22									1
BML300-10	300	10	23.5									1
BML300-12		12	23.5									1
BML300	300	0	23.5	1								
BML400		400	0	26.5	50	70					165	39
BML630	630	0	34	60	70	175					43.2	1

All dimensions in mm. Subject to technical changes.